

THE ARISTOCRAT OF HUNTING HANDGUNS - .357 and .44 AMP

# AUTO MAG

BY TDE CORPORATION



Exclusive Worldwide Distributor - L.E. JURRAS AND ASSOC., INC.



**LEE E. JURRAS**  
AND ASSOCIATES, INCORPORATED

EXCLUSIVE  
WORLDWIDE  
DISTRIBUTOR

**.357 & .44**  
**TDE® AUTO MAG**

The exclusive worldwide sales and distribution rights to the Auto Mag Pistol were assigned formally to L.E. Jurras and Associates, Inc. in September '74. The new company, located in Shelbyville, Indiana, is headed by L.E. Jurras. Founder and president of the Super Vel Cartridge Corp., international handgun hunter and author, Jurras is widely known as a devotee of all forms of handguns.

In addition to AMP distribution, L.E. Jurras and Associates, Inc. has assumed all warranty and service responsibilities including the supply of parts, accessories, custom work and special tuning. Ammunition and empty, unprimed cartridge cases will also be available through the company.

Much was written in the early part of '74, suggesting that the High Standard Co. would buy the manufacturing rights to and sell the AMP. Although High Standard did list the gun and some AMP's were made with their markings, the sale never did actually occur. Instead, in mid '74, the T.D.E. Corp. (manufacturers of the AMP) refinanced and tooled up to produce completely new guns to be distributed by the L.E. Jurras firm. Thus, for the first time, the Auto Mag will be fully supported by a corporate entity, completely separate from the manufacturing facility. New guns - from this date forward - distributed by L.E. Jurras and Associates, Inc. will carry the conventional T.D.E. markings and will also be enblazoned with the lion's head logo of the Jurras firm.



The .44 and .357 Auto Mag action is a unique short recoil, rotary bolt system. An accelerator throws the bolt back after the system is unlocked, starting the cycle which compresses the recoil springs located on each side of the frame, ejects the fired case, and, on return, picks up a fresh round, engages the locking splines and puts the gun in battery. The hold-open is activated by the magazine follower and locks the bolt back when the magazine is empty. This setup works smoothly and reliably with manageable recoil.

The .44 Auto Mag comes with target-type sights, featuring a non-glare ramp front, and a fully adjustable square blade rear. The two are connected by an integral ventilated rib which is part of the barrel assembly. This entire assembly is easily removed for cleaning, by locking the bolt to the rear, releasing the catch on the left front part of the frame and sliding the assembly forward.

When the barrel assembly is removed, the complete bolt assembly is exposed for cleaning or lubrication. The bolt has six locking lugs and operates within the frame by means of a large pin which is inserted through a cam slot in the bolt body in order to provide bolt rotation and retention.

The pistol is constructed of a stainless steel developed especially for the aerospace industry. Auto Mags are boxed in a black plastic carrying case with a set of Allen wrenches, a supply of Auto Mag lubricant and an instruction manual.

**AUTO MAG PISTOL**  
Choice of .357 or .44 with  
6½ or 8½ inch barrel

**\$495.00**

## AUTO MAG ACCESSORIES

### BARREL EXTENSIONS

.357 or .44 AMP	6½ inch	175.00
	8½ inch	180.00
	10 inch	185.00

### .357 AMP CARTRIDGES

137 gr. JSP (50 per box) \$18.50

### .44 AMP CARTRIDGES

JSP or JHP (50 per box) 18.50

EMPTY, UNPRIMED CASES *Case* 11.00

MAG-NA-PORTING 29.50

### BELT HOLSTERS, MODEL 103

(6½ inch bbl. only) *plain* 20.95  
*lined* 28.50

### SHOLDER HOLSTERS, MODEL 102

*Probably the most efficient hunting holster ever designed for the AMP. Suede lined, surgical elastic holds gun securely in holster. Orthopedic Elk shoulder harness. This model is made exclusively for L.E. Jurras and Assoc. by Safariland.*

Right Hand, 6½ inch Bbl. 40.00

Left Hand, 41.50

Right Hand, 8½ inch Bbl. 44.00

Left Hand, 45.50

Right Hand, 10 inch Bbl. 45.00

Left Hand, 46.50

CLIP POUCH, MODEL 104 9.95

MAGAZINES 16.50

CLIP DEPRESSORS 6.95

CUSTOM GRIPS  
Laminated Wood 37.50

CUSTOM TUNE-UP  
.357 or .44 AMP by L.E. Jurras 175.00  
*write for particulars*  
*- all models*

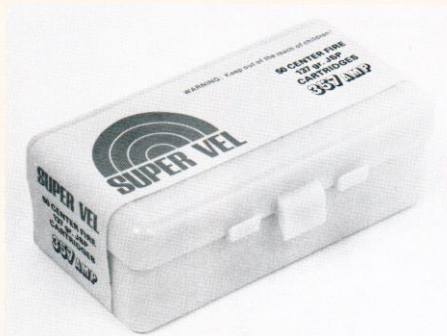

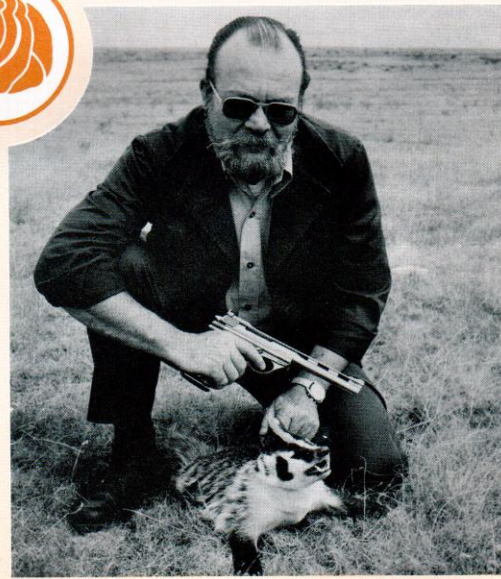
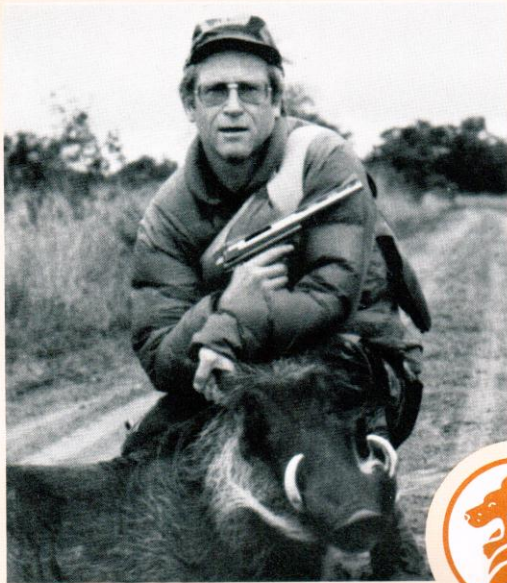

DEALER

EXCLUSIVE  
WORLDWIDE  
DISTRIBUTOR

**LEE E. JURRAS**  
AND ASSOCIATES, INCORPORATED

P.O. Box 163, Shelbyville, Indiana 46176  
Telephone: 317-525-4515 Cable: JURRAS



**LEE E. JURRAS**  
AND ASSOCIATES, INCORPORATED

P.O. Box 163, Shelbyville, Indiana 46176  
Telephone: 317-525-4515 Cable: JURRAS

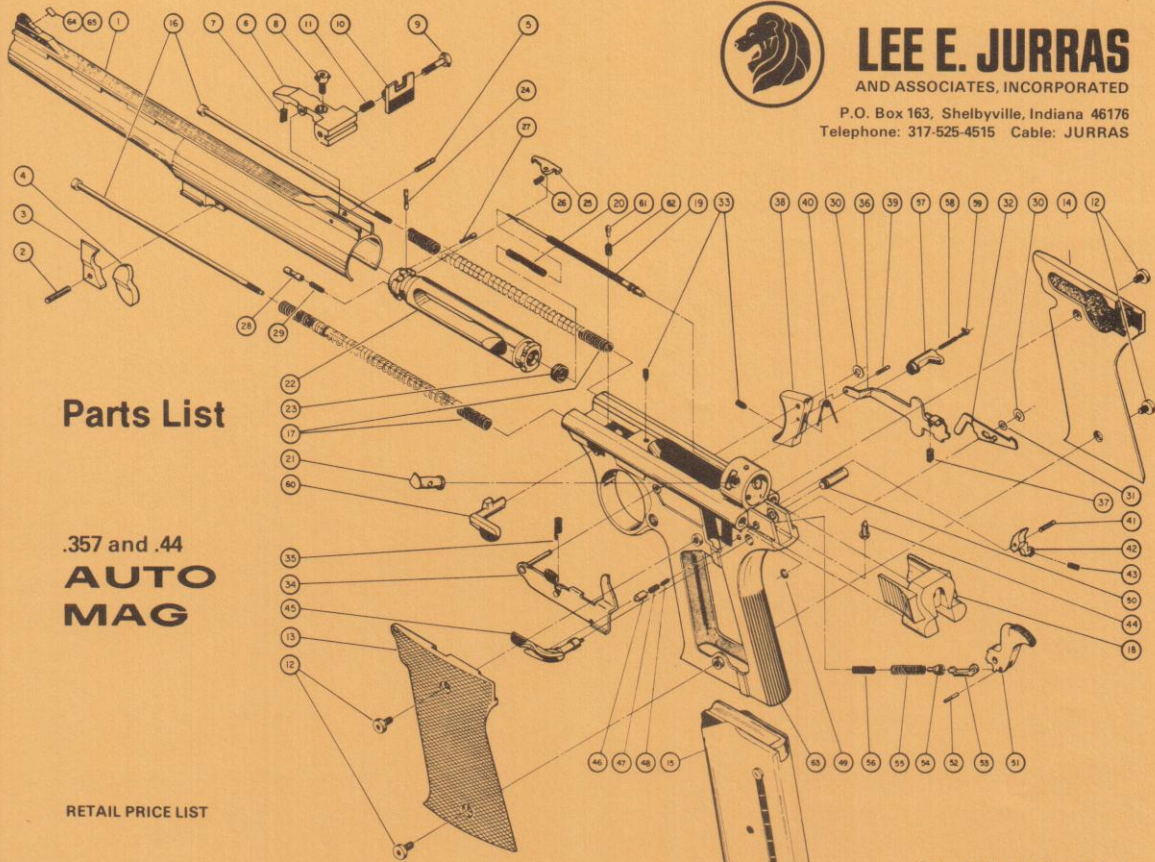

## Parts List

.357 and .44  
**AUTO  
MAG**

### RETAIL PRICE LIST

1.	Barrel & Extension Assy.	175.00	36.	Trigger Bar	6.55
2.	Accelerator Block Pin	1.25	37.	Trigger Bar Spring	.60
3.	Accelerator Block	13.65	38.	Trigger	8.30
4.	Accelerator	13.90	39.	Trigger Bar Pin	1.25
5.	Rear Sight Pin	1.25	40.	Trigger Spring	1.50
6.	Rear Sight Platform	14.15	41.	Sear Pin	1.25
7.	Rear Sight Elevation Spring	.25	42.	Sear	14.60
8.	Elevation Adjustment Screw Assy.	4.40	43.	Sear Spring	.35
9.	Windage Adjustment Screw Assy.	4.70	44.	Bolt Safety Tappet	3.75
10.	Rear Sight Blade	13.70	45.	Safety Lever	18.10
11.	Rear Sight Windage Spring	.25	46.	Safety Lever Detent Plunger	3.75
12.	Grip Screw	.15	47.	Safety Lever Detent Spring (Outer)	1.00
13.	Left Grip	6.55	48.	Safety Lever Detent Spring (Inner)	1.00
14.	Right Grip	6.55	49.	Hammer Pin Retaining Ring	.15
15.	Magazine Assy.	See Dealer Price List	50.	Hammer Pin	3.75
16.	Recoil Rod	4.15	51.	Hammer	12.75
17.	Recoil Spring	2.00	52.	Hammer Strut Pin	1.25
18.	Cocking Piece	16.55	53.	Hammer Strut	4.50
19.	Firing Pin	3.15	54.	Hammer Strut Guide	.45
20.	Firing Pin Spring	.45	55.	Hammer Spring (Outer)	.35
21.	Bolt Rotation Pin	6.70	56.	Hammer Spring (Inner)	.25
22.	Bolt	43.75	57.	Magazine Latch	7.20
23.	Bolt Rotation Spring	.65	58.	Magazine Latch Spring	.40
24.	Extractor Retaining Pin	.40	59.	Magazine Latch Retainer	.75
25.	Extractor	10.15	60.	Barrel Latch	3.00
26.	Extractor Spring	.85	61.	Barrel Latch Detent Plunger	.40
27.	Ejector Retaining Pin	.40	62.	Barrel Latch Detent Spring	.85
28.	Ejector	.70	63.	Frame	N/A
29.	Ejector Spring	.15			
30.	Retaining Ring	.15			
31.	Safety Plate Spacer	3.75			
32.	Safety Plate	6.55			
33.	Trigger Adjustment Screw	.90			
34.	Holdopen Assy.	8.75			
35.	Holdopen Spring	1.25			

Effective September 1974  
Prices subject to change  
without notice.

LIST PRICES ARE SUBJECT TO A 25% DEALER DISCOUNT.

Effective September 1974.  
Prices subject to change  
without notice.

EXCLUSIVE DISTRIBUTORS OF AUTO MAG PISTOLS AND ACCESSORIES

AUTO MAG PARTS AND ACCESSORIES, CONFIDENTIAL  
**DEALER PRICE LIST**



**LEE E. JURRAS**  
AND ASSOCIATES, INCORPORATED

P.O. Box 163, Shelbyville, Indiana 46176  
Telephone: 317-525-4515 Cable: JURRAS

DESCRIPTION	DEALER COST	SUGGESTED RETAIL
.357 AMP and .44 AMP 6½ or 8½ inch Barrel	\$396.00	\$495.00
.357 AMP and .44 AMP Barrel Extensions	6½ inch 150.00 8½ inch 155.00 10 inch 160.00	175.00 180.00 185.00
Extra Magazines	13.50	16.50
Custom Laminated Wood Grips	32.50	37.50
Mag-Na-Porting	22.50	29.50
Clip Depressors	5.95	6.95
Shoulder Holsters Model 102	<i>Probably the most efficient hunting holster ever designed for the Auto Mag. Suede lined, surgical elastic holds gun securely in holster. Shoulder harness is Orthopedic Elk. This model is made exclusively for LEJ by Safariland.</i>	
Right Hand, 6½ inch Bbl. Left Hand,	28.00 29.05	40.00 41.50
Right Hand, 8½ inch Bbl. Left Hand,	30.80 31.85	44.00 45.50
Right Hand, 10 inch Bbl. Left Hand,	31.50 32.55	45.00 46.50
Belt Holsters (6½ inch Bbl. Only) Model 103	Plain 14.67 Lined 19.95	20.95 28.50
Clip Pouch, Model 104	6.97	9.95
Custom Tune-up .357 AMP or .44 AMP By L.E. Jurras	150.00	175.00 All Models / Write For Particulars
.357 AMP Cartridges 137 gr. JSP (50 per box)	13.88	18.50
.44 AMP Cartridges JSP or JHP (50 per box)	13.88	18.50