

AUTO MAG

THE ARISTOCRAT OF BIG BORE HANDGUNS

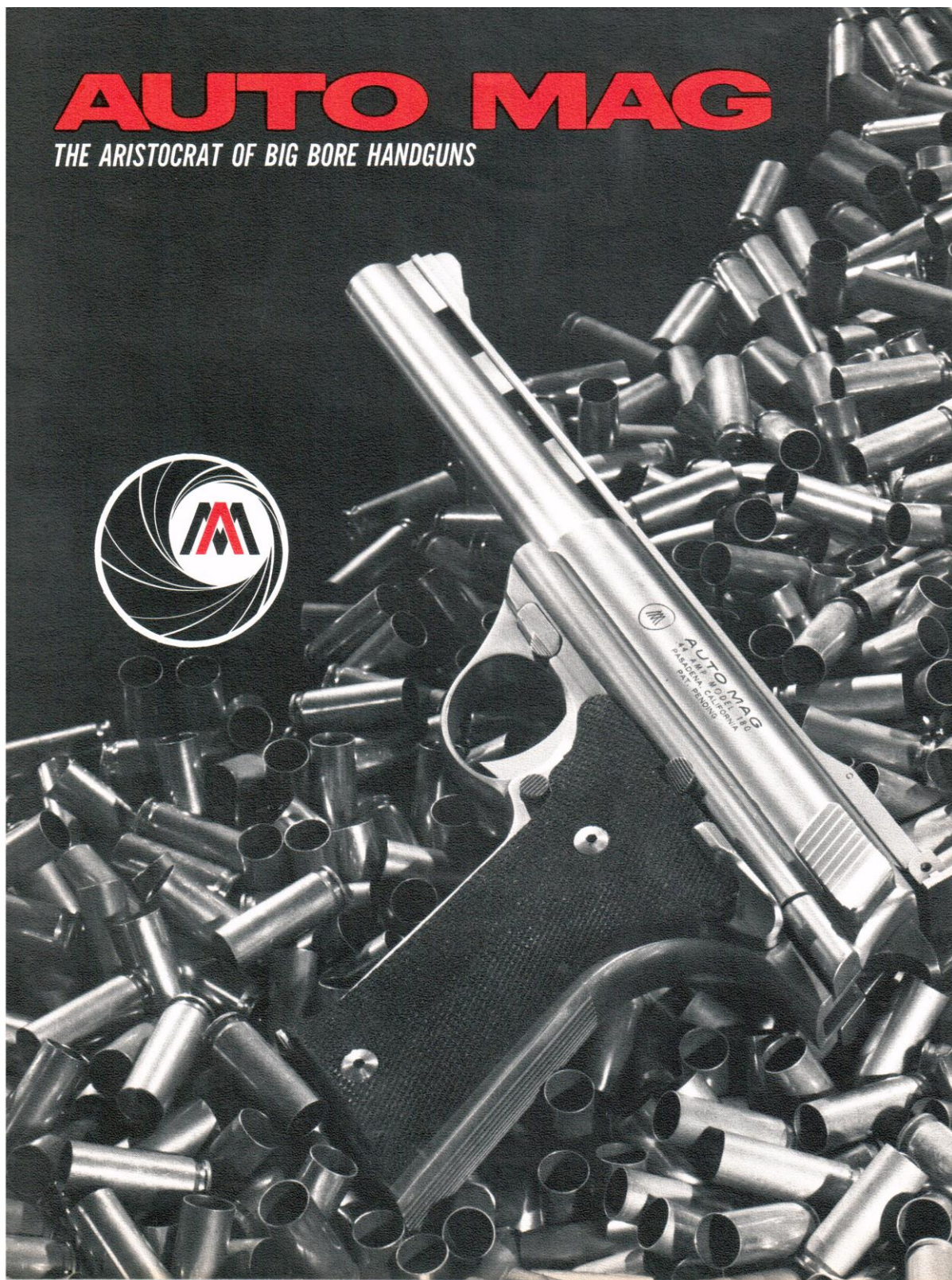

THE AUTO MAG CONCEPT

The .44 Auto Mag represents a whole new, exciting concept in autoloading pistol design and technology. Use space-age stainless steels—combine them with the strong, dependable, locking system of a high-powered rifle—the accuracy and efficiency of the finest target pistol—the big bore stopping power of the .44 magnum and a very handsome appearance—add the interchangeability of calibers and you have the Auto Mag—truly the aristocrat of big bore handguns.

Due to the unique design, you can switch from .44 AMP to .357 AMP "quick as a wink" using the new conversion unit—you use the same magazine—have the same trigger pull—the same grip and balance at about half the cost of two guns. Buy one complete gun in either caliber and add the conversion unit later on—whichever way you go, you end up with tomorrow's pistol today—the Auto Mag.

Model 180 — .44 Auto Mag \$275.00
 Model 160 — .357 Auto Mag \$275.00
 Conversion Unit in Either Caliber \$150.00



AUTO MAG SPECIFICATIONS

	.44 AUTO MAG	.357 AUTO MAG
Bbl. Length:	6½"	6½"
Rifling:	8 Lands, 8 Grooves	8 Lands, 8 Grooves
Land Width:	.0467"	.052"
Groove Width:	.119"	.090"
Groove Depth:	.004	.004
Rate of Twist:	1 Turn in 18"	1 Turn in 18"
Caliber:	.44 AMP	.357 AMP
Sights:	Target	Target
Action:	Autoloading, Short Recoil	Autoloading, Short Recoil
Magazine Cap:	7 Rounds	7 Rounds
Stocks:	Polyurethane	Polyurethane
Trigger:	Adjustable Travel Target Type	Adjustable Travel Target Type
Hammer:	Exposed	Exposed
Finish:	Polished BBL., Matte Frame	Polished BBL., Matte Frame
Weight:	57 Ounces	54 Ounces
Overall Length:	11½"	11½"



FEATURES

The .44 and .357 Auto Mag action is a rotary bolt system. An accelerator tip after the system is unlocked, starting it presses the recoil springs located on either side of the bolt, which forces the bolt back, ejects the fired case, and, on return, the bolt engages the locking splines and puts the bolt back in the locked position. The hold-open is activated by the magazine bolt back when the magazine is empty. The system operates smoothly and reliably with manageable recoil.

The .44 Auto Mag comes with target type front sight, a glare ramp front, and a fully adjustable engraved outline. The two are connected by a hinge which is part of the barrel assembly. The front sight can be removed for cleaning, by locking the bolt back and catching on the left front part of the frame.

When the barrel assembly is removed, the bolt is exposed for cleaning or lubrication. The bolt operates within the frame by means of a cam slot in the bolt body in order to maintain retention.

The pistol is constructed of a stainless steel case with an extra magazine, a set of Auto Mag lubricant and an instruction manual.

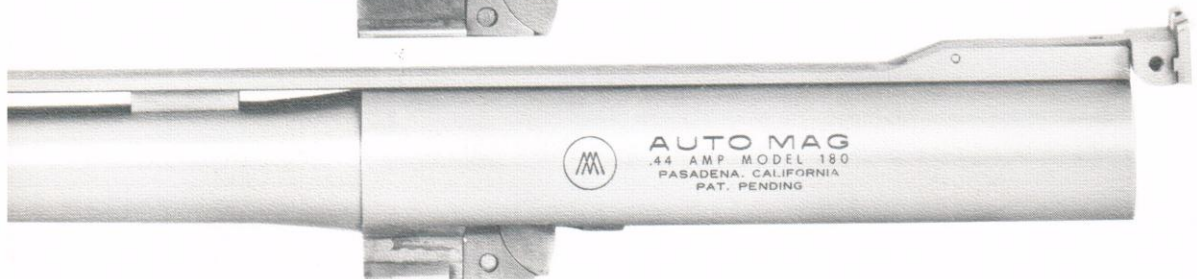
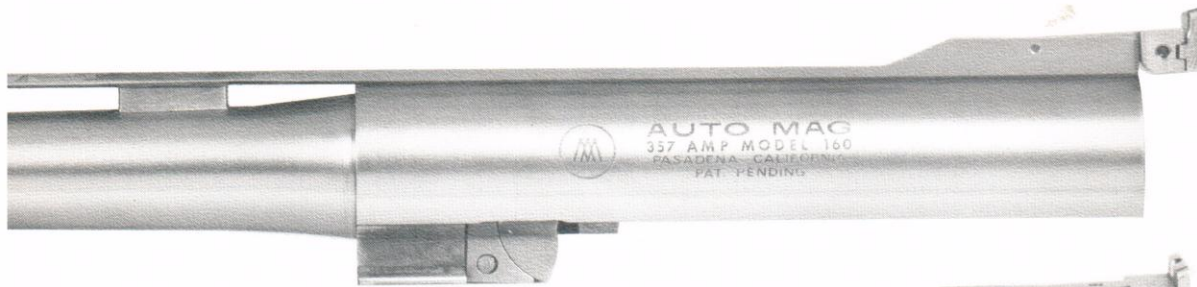

ie short recoil,
the bolt back
cle which com-
de of the frame,
ip a fresh round,
n in battery. The
wer and locks the
tup works smooth-

its, featuring a non-
e blade rear with an
integral ventilated rib
ire assembly is easily
he rear, releasing the
d sliding the assembly

plete bolt assembly is
as six locking lugs and
ge pin which is inserted
provide bolt rotation and

developed especially for
d in a black plastic carry-
wrenches, a supply of

COMING SOON!

THE AUTOMAG CONCEPT IN .45 ACP

We'll be introducing the Auto Mag in .45 ACP soon. It will be the first really new handgun developed in this world-famous caliber to come along since the venerated old 1911 model designed by John Browning.

Almost a century of progress in handgun design and metallurgical skills are combined to bring you this new, exciting, autoloading pistol.

It's a scaled-down version of the big .44 and .357 Auto Mag with the accuracy of the finest target pistols and a lack of tough-to-handle recoil that will amaze you.

We will be delivering our first .45 ACP models in September of this year. Order yours now from your dealer for early delivery. Estimated price: \$225.00.

THE AUTO MAG CONCEPT

The .44 Auto Mag represents a whole new, exciting concept in autoloading pistol design and technology. Use space-age stainless steels—combine them with the strong, dependable, locking system of a high-powered rifle—the accuracy and efficiency of the finest target pistol—the big bore stopping power of the .44 magnum and a very handsome appearance—add the interchangeability of calibers and you have the Auto Mag—truly the aristocrat of big bore handguns.

Due to the unique design, you can switch from .44 AMP to .357 AMP "quick as a wink" using the new conversion unit—you use the same magazine—have the same trigger pull—the same grip and balance at about half the cost of two guns. Buy one complete gun in either caliber and add the conversion unit later on—whichever way you go, you end up with tomorrow's pistol today—the Auto Mag.

Model 180 — .44 Auto Mag \$275.00
 Model 160 — .357 Auto Mag \$275.00
 Conversion Unit in Either Caliber \$150.00



AUTO MAG SPECIFICATIONS

	.44 AUTO MAG	.357 AUTO MAG
Bbl. Length:	6½"	6½"
Rifling:	8 Lands, 8 Grooves	8 Lands, 8 Grooves
Land Width:	.0467"	.052"
Groove Width:	.119"	.090"
Groove Depth:	.004	.004
Rate of Twist:	1 Turn in 18"	1 Turn in 18"
Caliber:	.44 AMP	.357 AMP
Sights:	Target	Target
Action:	Autoloading, Short Recoil	Autoloading, Short Recoil
Magazine Cap:	7 Rounds	7 Rounds
Stocks:	Polyurethane	Polyurethane
Trigger:	Adjustable Travel Target Type	Adjustable Travel Target Type
Hammer:	Exposed	Exposed
Finish:	Polished BBL., Matte Frame	Polished BBL., Matte Frame
Weight:	57 Ounces	54 Ounces
Overall Length:	11½"	11½"

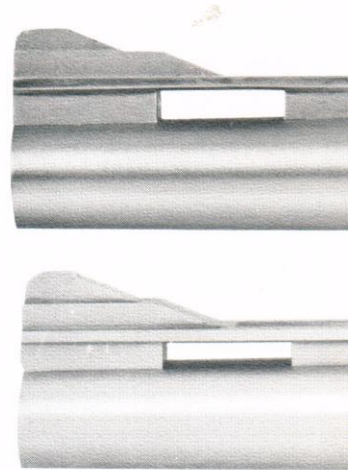

FEATURES

The .44 and .357 Auto Mag action is a rotary bolt system. An accelerator th after the system is unlocked, starting t presses the recoil springs located on ea ejects the fired case, and, on return, p engages the locking splines and puts t hold-open is activated by the magazine bolt back when the magazine is empty. T ly and reliably with manageable recoil.

The .44 Auto Mag comes with target ty glare ramp front, and a fully adjustable engraved outline. The two are connected which is part of the barrel assembly. Th removed for cleaning, by locking the bo catch on the left front part of the fran forward.

When the barrel assembly is removed, th exposed for cleaning or lubrication. The operates within the frame by means of through a cam slot in the bolt body in orc retention.

The pistol is constructed of a stainless the aerospace industry. Auto Mags are ing case with an extra magazine, a set Auto Mag lubricant and an instruction m

.44 AMP JHP FACTORY AMMUNITION

.44 AMP factory-loaded ammunition, virgin brass and JHP bullets are now available. Ask your dealer to order.

This special ammunition, designed by Auto Mag ballistics engineers expressly for maximum accuracy, stopping power and smooth functioning in the .44 Auto Mag is produced by one of the world's leading ammunition manufacturers and marketed by Auto Mag.

The 240 grain JHP bullet, designed for smooth feeding has a hollow point cavity that is designed for maximum expansion properties while retaining excellent cross-section density.

Cases are formed from virgin brass under the latest manufacturing techniques and held to close tolerances for efficient functioning.

Velocities are in the range of 1375 fps with pressures of approximately 30,000 psi.

DIMENSIONS FOR FORMING .44 AMP AND .357 AMP CASES FROM .308 BRASS

HAND LOADING: .44 Auto Mag cartridges can be manufactured from surplus .308 military brass using any large, or large Magnum Pistol Primers, Standard Pistol Powders and any of a wide variety of .44 handgun bullets.

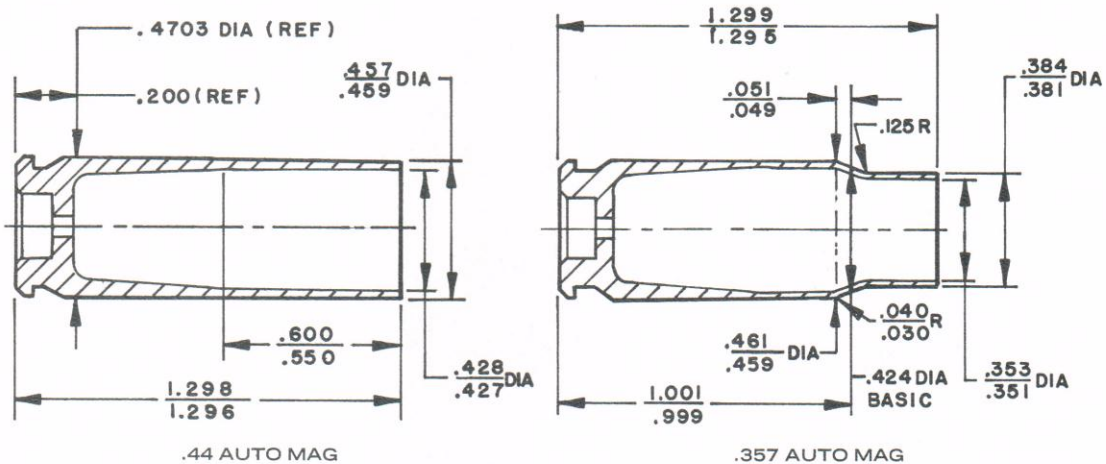

The .357 Auto Mag cartridge is formed by running the .44 AMP cartridge into a .357 Auto Mag sizing die. It will handle bullets from 90 to 158 grains, with velocities exceeding 2,000 fps obtainable with the lighter bullets. Detailed information on ballistics, factory brass and loaded ammunition will be published as quickly as possible.

R.C.B.S. die and reamer sets are available for both calibers. Order from your Auto Mag dealer.

.44 AMP LOADING DATA

Test Gun: Production .44 Auto Mag Pistol with 6½" bbl., Twist: One in 18", Groove Diameter: .430", Bore Diameter: .422, Temperature: 68°F, Primers: CCI 350

BULLET	POWDER	VELOCITY (F.P.S.)	BULLET	POWDER	VELOCITY (F.P.S.)
180 Gr.	24 Gr. 630-P	1653	200 Gr.	22 Gr. 2400	1485
180 Gr.	25 Gr. 630-P	1687	200 Gr.	23 Gr. 2400	1561
180 Gr.	26 Gr. 630-P	1751	200 Gr.	24 Gr. 2400	1574
180 Gr.	20 Gr. 1020	1482	240 Gr.	10 Gr. Unique	1230
180 Gr.	21 Gr. 1020	1605	240 Gr.	12 Gr. Unique	1346
180 Gr.	25 Gr. 2400	1596	240 Gr.	17 Gr. 630-P	1259
180 Gr.	26 Gr. 2400	1659	240 Gr.	18 Gr. 630-P	1319
200 Gr.	18 Gr. 1020	1402	240 Gr.	19 Gr. 630-P	1384
200 Gr.	19 Gr. 1020	1525	240 Gr.	20 Gr. 630-P	1428
200 Gr.	20 Gr. 1020	1585	240 Gr.	18 Gr. 2400	1252
200 Gr.	22 Gr. 630-P	1570	240 Gr.	20 Gr. 2400	1378
200 Gr.	23 Gr. 630-P	1624	240 Gr.	21 Gr. 2400	1435
200 Gr.	24 Gr. 630-P	1680	240 Gr.	22 Gr. 2400	1479
200 Gr.	23 Gr. 4227	1303	240 Gr.	15 Gr. 1020	1245
200 Gr.	24 Gr. 4227	1375	240 Gr.	16 Gr. 1020	1329

NOTES

These are suggested loads to provide best functioning — do not exceed maximum loads listed — be sure primers are fully seated to bottom of primer pocket—any large, or large magnum pistol primers can be used. Seat bullets for overall cartridge length of 1.600".

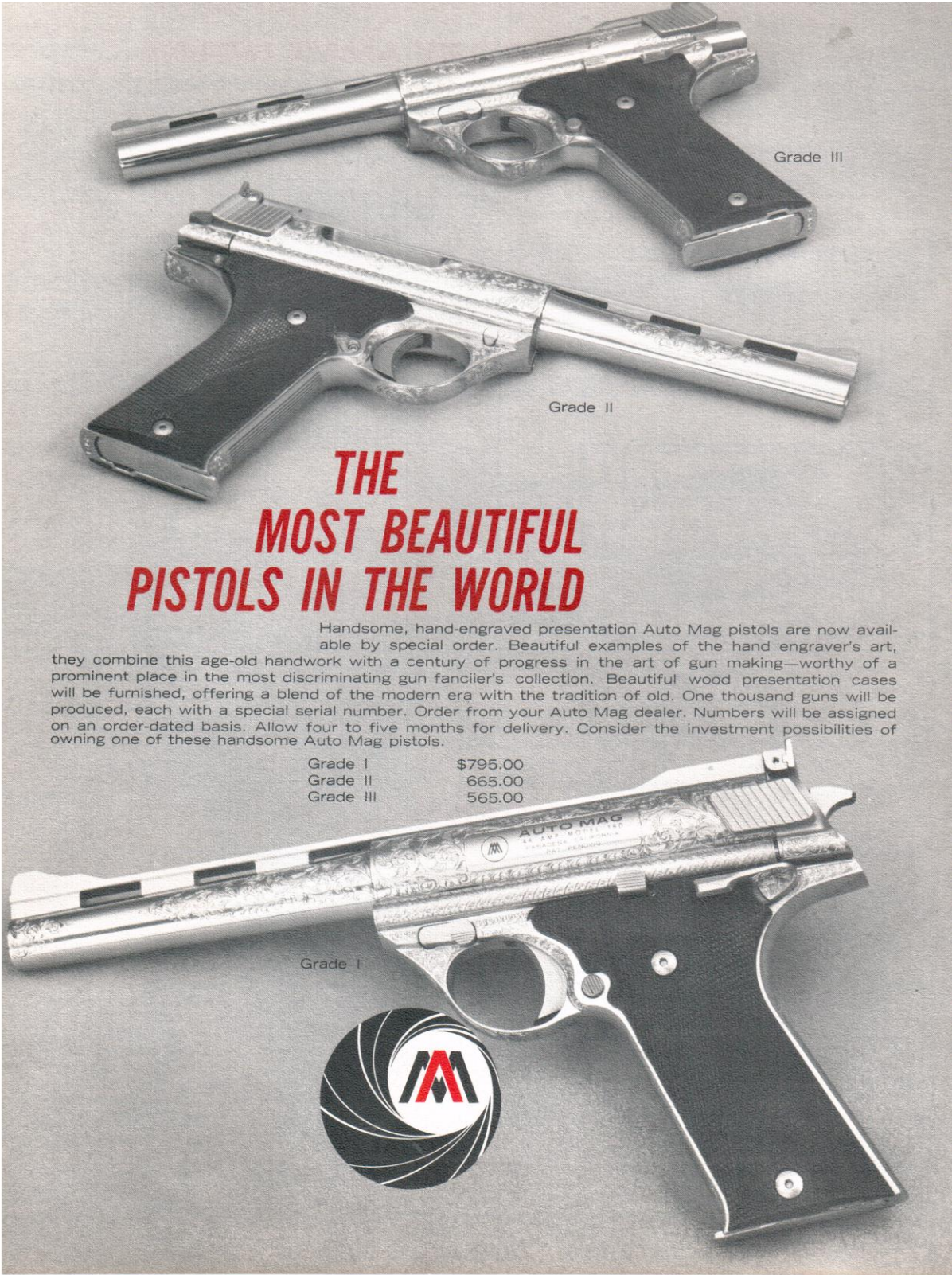

Grade III

Grade II

Grade I

THE MOST BEAUTIFUL PISTOLS IN THE WORLD

Handsome, hand-engraved presentation Auto Mag pistols are now available by special order. Beautiful examples of the hand engraver's art, they combine this age-old handwork with a century of progress in the art of gun making—worthy of a prominent place in the most discriminating gun fancier's collection. Beautiful wood presentation cases will be furnished, offering a blend of the modern era with the tradition of old. One thousand guns will be produced, each with a special serial number. Order from your Auto Mag dealer. Numbers will be assigned on an order-dated basis. Allow four to five months for delivery. Consider the investment possibilities of owning one of these handsome Auto Mag pistols.

Grade I	\$795.00
Grade II	665.00
Grade III	565.00



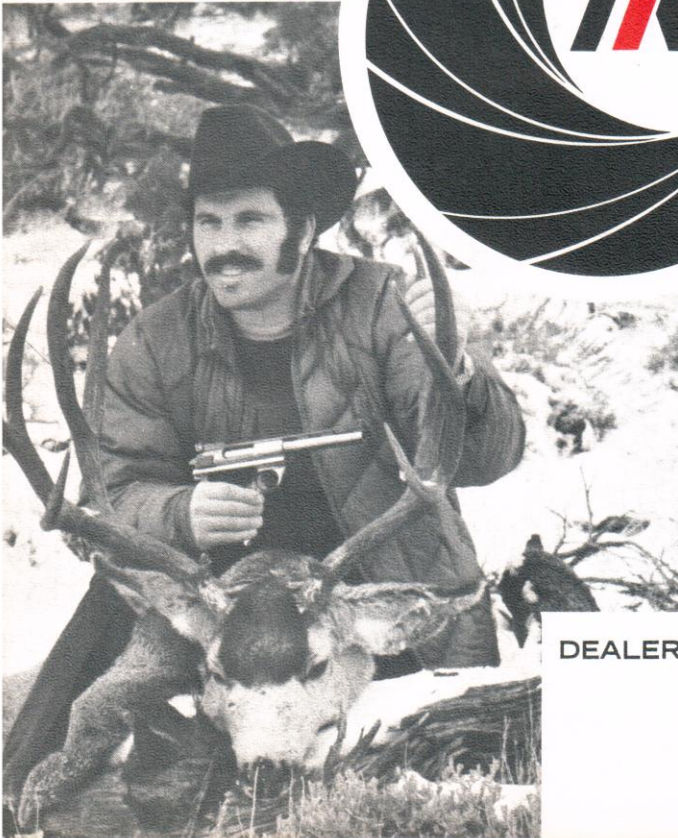

DEALER: